



## 90 CONWAY GARDENS

GRAYS, RM17 6HG

£200,000  
LEASEHOLD

\*\*\*Offers around £200,000 - £220,000\*\*\*

Welcome to this charming two-bedroom ground floor apartment located in the desirable area of Conway Gardens, Grays, RM17 6HG. This property, built between 1980 and 1989, offers a perfect blend of comfort and convenience, making it an ideal choice for first-time buyers or those looking to downsize.

As you enter the apartment, you will find a spacious reception room that provides a warm and inviting atmosphere, perfect for relaxing or entertaining guests. The two well-proportioned bedrooms offer ample space for rest and relaxation, while the modern bathroom ensures your daily routines are both comfortable and efficient.

**tm**  
thomas marsh

Ground Floor

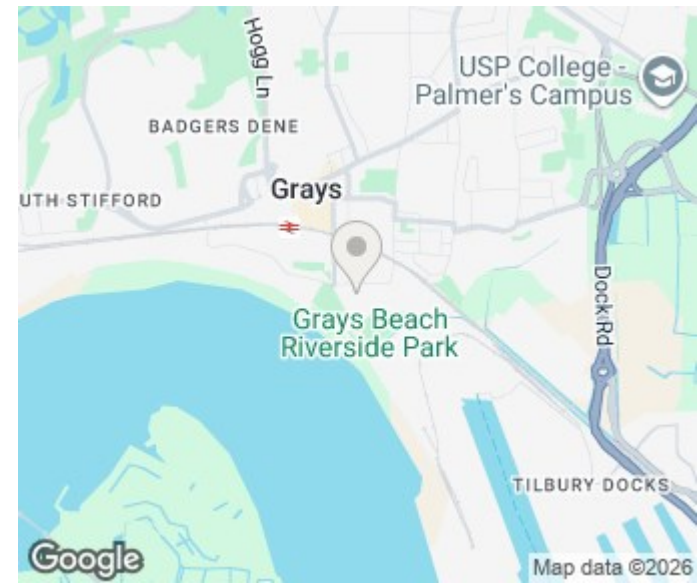
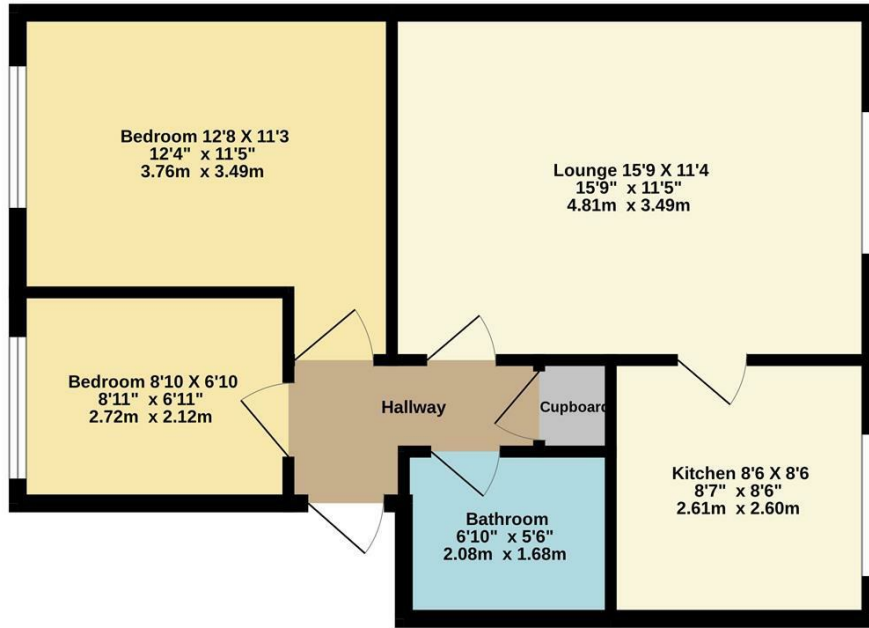

Energy Efficiency Rating		Current	Potential
Very energy efficient - lower running costs			
(92 plus) A			
(81-91) B			
(69-80) C			79
(55-68) D		61	
(39-54) E			
(21-38) F			
(1-20) G			
Not energy efficient - higher running costs			
England & Wales		EU Directive 2002/91/EC	

Agents Note: Whilst every care has been taken to prepare these particulars, they are for guidance purposes only. All measurements are approximate and are for general guidance purposes only and whilst every care has been taken to ensure their accuracy, they should not be relied upon and potential buyers/tenants are advised to recheck the measurements

Grays Sales  
47 Orsett Road  
Grays  
Essex  
RM17 5HJ

01375 370779  
sales@thomas-marsh.com  
www.thomas-marsh.com

